

RM-MS Multistage, magnetically coupled centrifugal pump

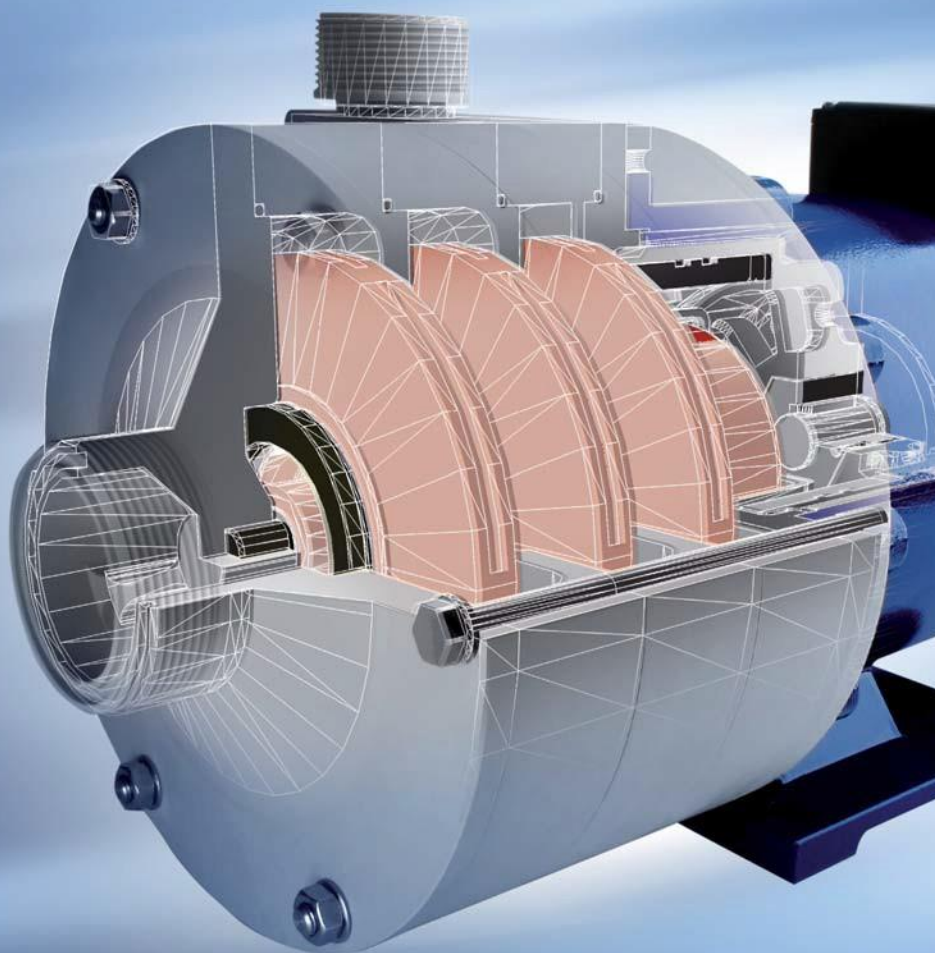

RM-MS, efficient
pumping of chemicals
with high pressure.



INNOVATIVE PUMP
AND FILTER TECHNOLOGY

Competence in pump
and filter technologies

Increased efficiency in high pressure applications with multistage, magnetically coupled pump RM-MS.

The advantages of type RM-MS at a glance:

- ◆ Energy efficient in high pressure operation
- ◆ Flexible and modular design
- ◆ Multistage with 1, 2, or 3 impeller
- ◆ Driven by magnetic coupling
- ◆ Best hydraulic efficiency
- ◆ Environment friendly by hermetically sealed pump housing
- ◆ Best chemical resistance
- ◆ Metal-free design made of PP or PVDF

Performance charts type RM-MS

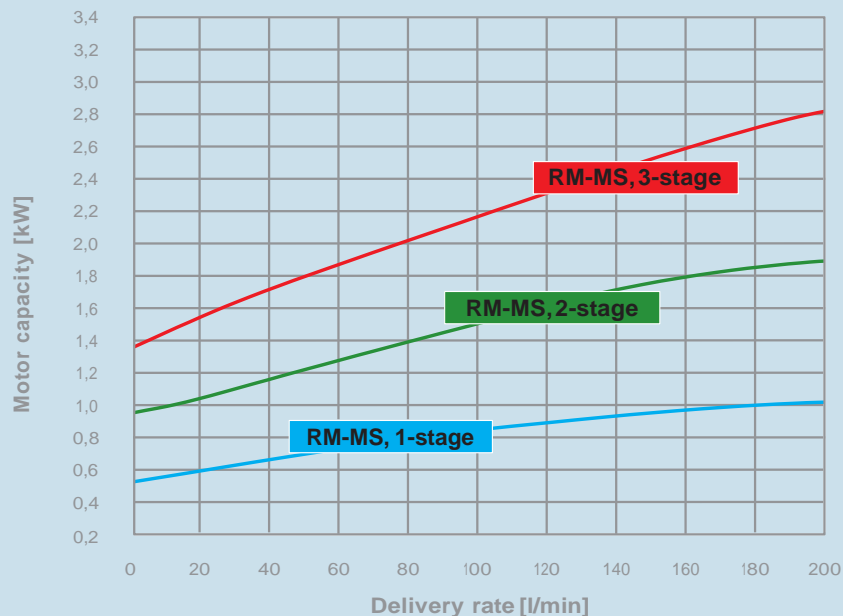
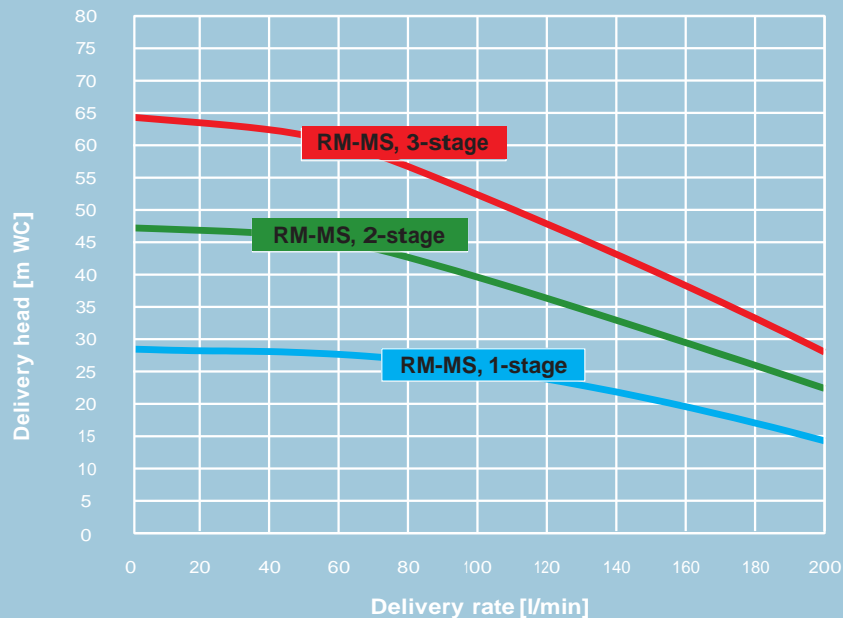

In high pressure applications single-stage centrifugal pumps are not very efficient. For operation in high pressure ranges multistage centrifugal pumps are required. That is to say, multiple centrifugal pumps respectively impellers are connected in series. In series connection the delivery heights will add together. In high pressure ranges the type RM-MS will reach a higher efficiency than a single-stage centrifugal pump for higher delivery rates, which works in unfavorable operational area.



NEW!

Technical data

| size | RM-MS, 1-stage | RM-MS, 2-stage | RM-MS, 3-stage |
|-------------------------------------|-----------------------|-----------------------|----------------|
| maximum delivery rate [l/min] | 200 | 200 | 200 |
| maximum delivery head [m WC] | 28 | 47 | 65 |
| motor capacity [kW] | 0,75 – 3,0 | | |
| voltage at 50 Hz [V] | 220 – 240 / 380 – 415 | | |
| voltage at 60 Hz [V] | 255 – 277 / 440 – 480 | | |
| protection class | IP 55 | | |
| connections | suction side G 2 1/4 | pressure side G 1 1/2 | |
| materials | PP | PVDF | |
| max. temperature [° C] | 80 | 90 | |
| max. system pressure at 20° C [bar] | 8,0 | 8,0 | |

Types and sizes

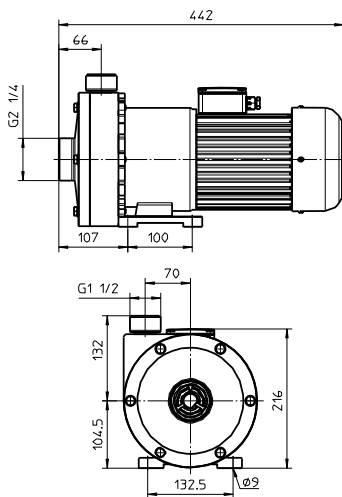

RM-MS, 1-stage
1,5 kW

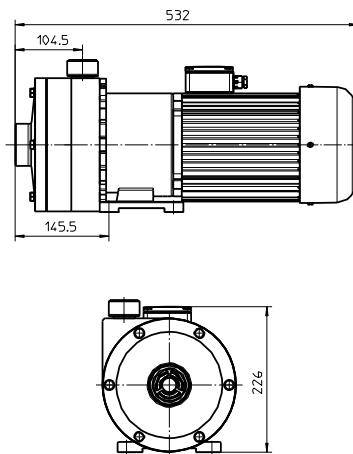

RM-MS, 2-stage
2,2 kW

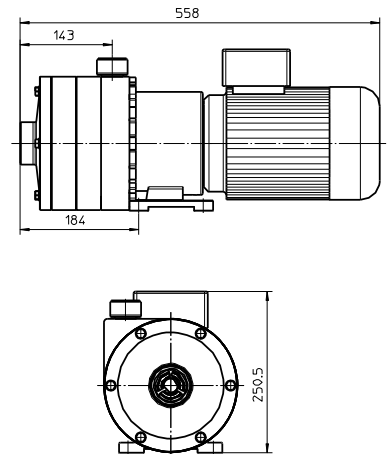

RM-MS, 3-stage
3,0 kW

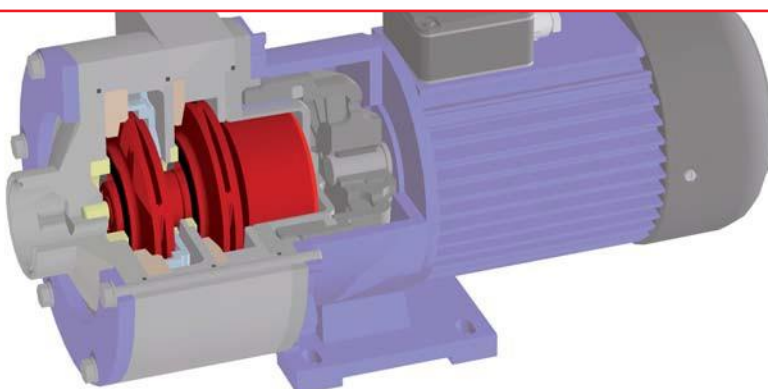

Competence in pump and filter technology. Over 50 years of excellent product quality, reliable service and enduring experience.

RENNER's RPR Control-100 for electronic process monitoring of pumps.



Separate programming unit
Hand-held programmer with cable and plug to program specific switching thresholds to RPR Control-100 1 and 100 3 systems

Users of centrifugal pumps are only too well aware of the problem that most pumps do not fail because of progressive wear but, long before their end of life, due to critical operating conditions like dry running, overheating or operation in cavitation.

The active-power meter integrated to the RPR Control-100 system has 4 user-programmable switching thresholds assigned to the following operating conditions:

- ◆ Dry running
- ◆ Overheating
- ◆ Overload
- ◆ Flow rate falling below minimum value



RPR Control-100 1
to be built into control cabinets and plug in the separate programming unit (mounted on top-hat rail)



Portable RPR Control-100 3
with indicating lamps and push-buttons but without programming unit



RPR Control-100 2
to be built into control cabinets with integrated programming unit (mounted on top-hat rail)

Our product specialists will be glad to help you. Please take contact to your personal advisor– by phone or eMail:

(800) 367 3589

info@fluxpumpsusa.com

FLUX Pumps Corporation
300 Townpark Drive, Suite 110
Kennesaw, GA 30144
Tel. (800) 367 3589
Fax (404) 691 6314
info@fluxpumpsusa.com
www.fluxpumpsusa.com